

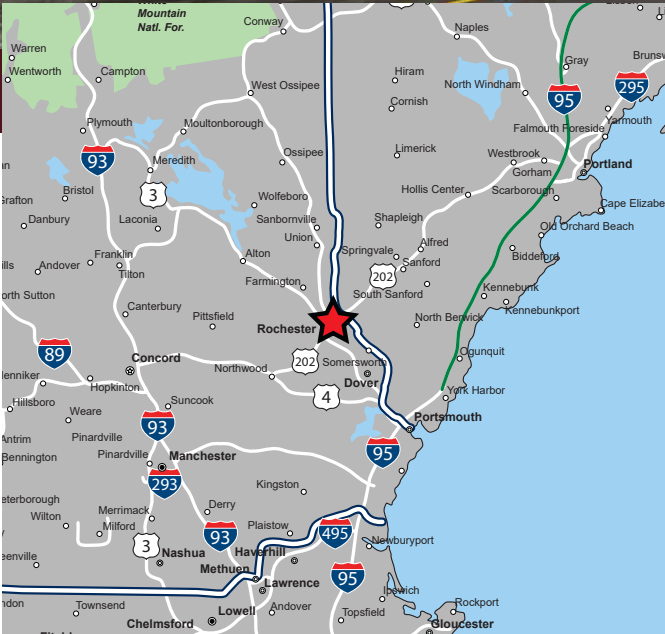

JOIN LILAC CLUB CASINO

7 Milton Road (Route 125), Rochester, New Hampshire



AVAILABLE FOR LEASE

PROPERTY HIGHLIGHTS

- » Up To 39,067 SF Existing Space Available
- » Up To 49,945 SF Interior Mall Space Available
- » Up To 3,700 SF Pad Site Available w/Drive-Thru
- » Anchored by Full Service Casino - Now Open
- » 22,165 SF Hotel - Under Construction
- » Shadow Anchored by Hannaford
- » Multiple Uses Allowed
- » Regional Trade Area



JOIN LILAC CLUB CASINO

7 Milton Road (Route 125), Rochester, New Hampshire



JOIN LILAC CLUB CASINO

7 Milton Road (Route 125), Rochester, New Hampshire



EASTERN
RETAIL PROPERTIES

Existing Plan

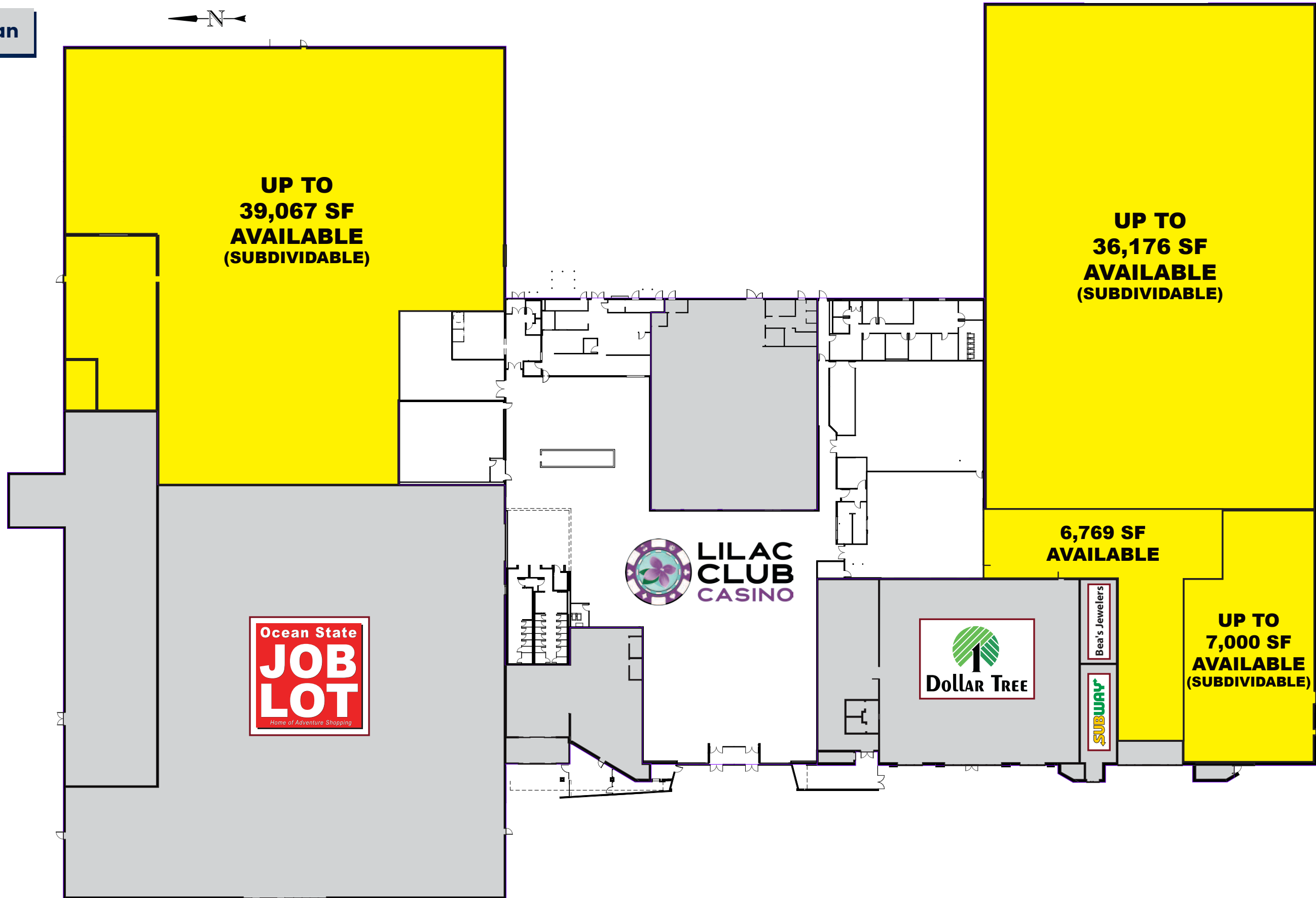

EXISTING SUPERMARKET
± 64,141 SF



Join Lilac Club Casino - 7 Milton Road (Route 125), Rochester, New Hampshire



EASTERN
RETAIL PROPERTIES

FOR MORE INFORMATION CONTACT:

Sam Peterson

781.849.9016

speterson@easternretail.com

Joe Morrison

781.264.6225

jmorrison@easternretail.com

P 781.849.9010 + F 781.849.9050 + www.easternretail.com + 25 Braintree Hill Office Park, Suite 404 + Braintree, MA 02184

The information above has been obtained from sources believed reliable. While we do not doubt its accuracy, we have not verified it and make no guarantee, warranty or representation about it. It is your responsibility to independently confirm its accuracy and completeness. Any projections, opinions, assumptions or estimates used are for example only and do not represent the current or future performance of the property. The value of this transaction to you depends on tax and other factors, which should be evaluated by your tax and financial advisors. You and your advisors should conduct a careful, independent investigation of the property to determine to your satisfaction, the suitability of the property for your needs.