

# JOIN LILAC CLUB CASINO

7 Milton Road (Route 125), Rochester, New Hampshire



**AVAILABLE FOR LEASE**

## PROPERTY HIGHLIGHTS

- » Up To 39,067 SF Existing Space Available
- » Up To 49,945 SF Interior Mall Space Available
- » Up To 3,700 SF Pad Site Available w/Drive-Thru
- » Anchored by Full Service Casino - Now Open
- » Shadow Anchored by Hannaford
- » Multiple Uses Allowed
- » Regional Trade Area

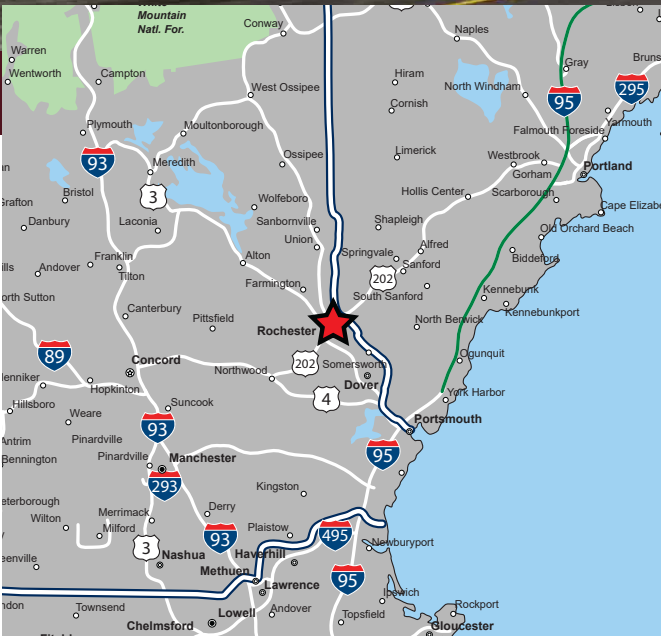

P 781.849.9010 + F 781.849.9050 + [www.easternretail.com](http://www.easternretail.com)



**EASTERN**  
RETAIL PROPERTIES



# JOIN LILAC CLUB CASINO

7 Milton Road (Route 125), Rochester, New Hampshire





# JOIN LILAC CLUB CASINO

7 Milton Road (Route 125), Rochester, New Hampshire



**EASTERN**  
RETAIL PROPERTIES

Existing Plan

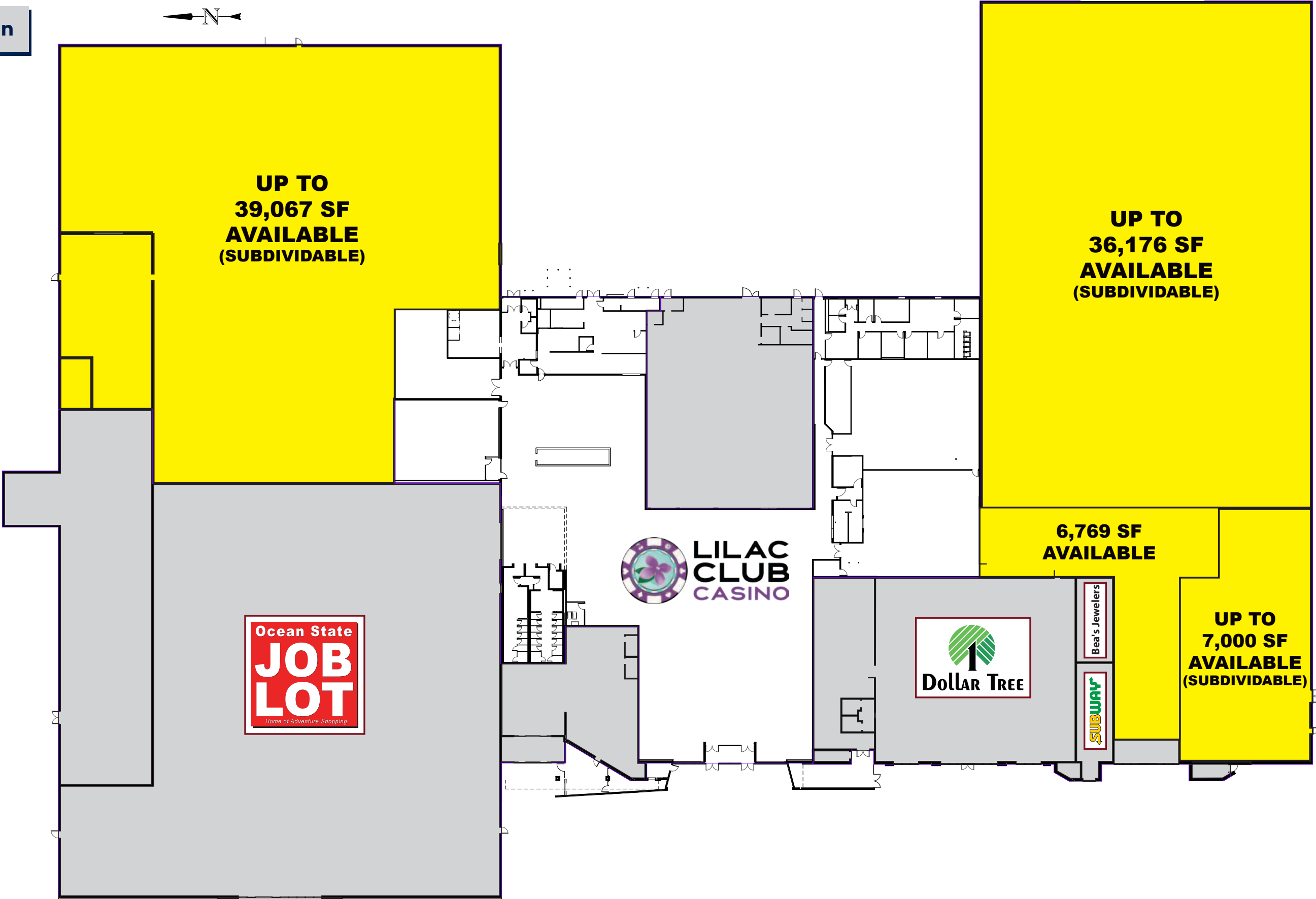

**EXISTING SUPERMARKET  
± 64,141 SF**

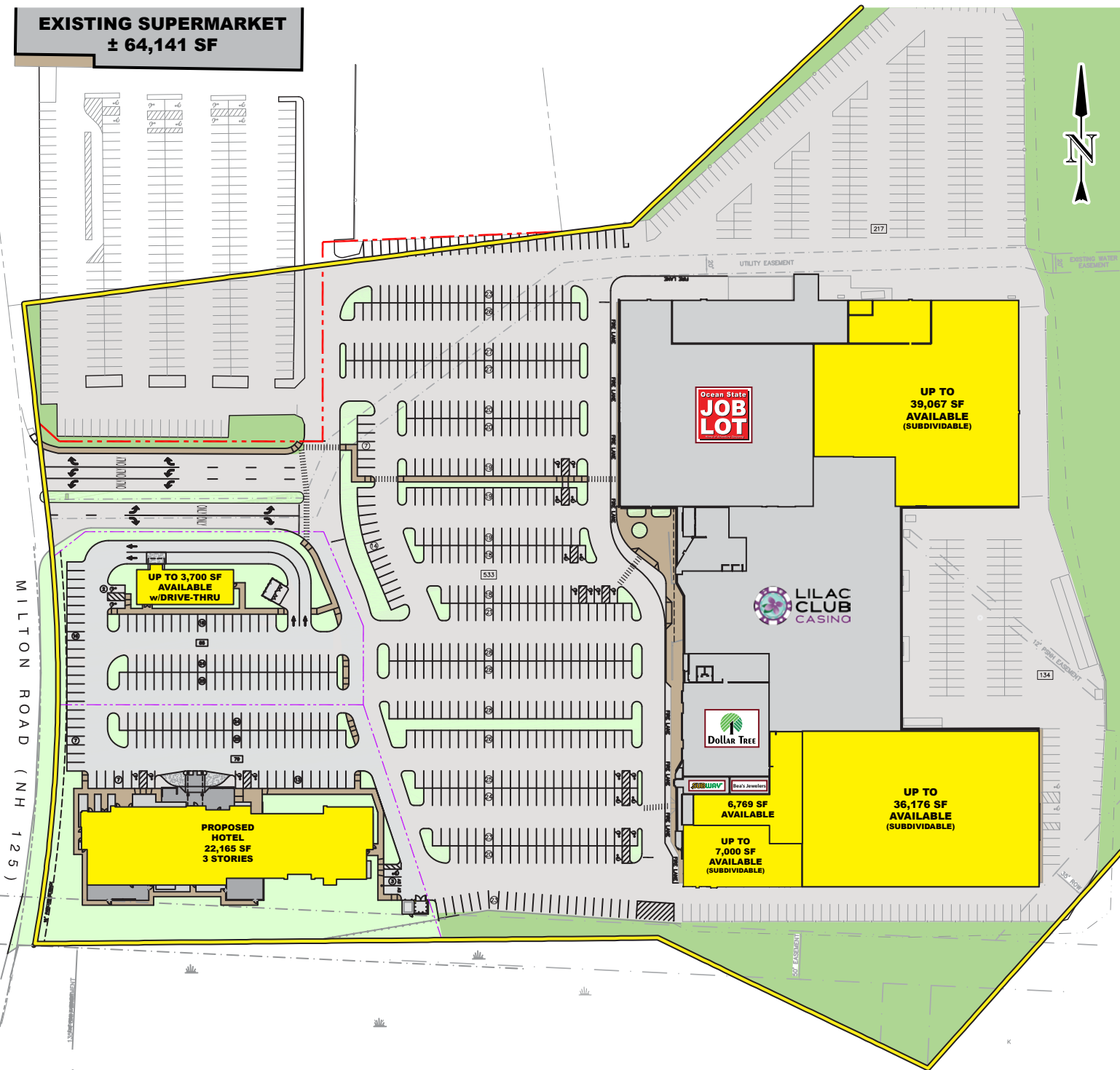

**Join Lilac Club Casino - 7 Milton Road (Route 125), Rochester, New Hampshire**



**EASTERN**  
RETAIL PROPERTIES

FOR MORE INFORMATION CONTACT:

**Sam Peterson**

781.849.9016

speterson@easternretail.com

**Joe Morrison**

781.264.6225

jmorrisson@easternretail.com

P 781.849.9010 + F 781.849.9050 + [www.easternretail.com](http://www.easternretail.com) + 25 Braintree Hill Office Park, Suite 404 + Braintree, MA 02184

The information above has been obtained from sources believed reliable. While we do not doubt its accuracy, we have not verified it and make no guarantee, warranty or representation about it. It is your responsibility to independently confirm its accuracy and completeness. Any projections, opinions, assumptions or estimates used are for example only and do not represent the current or future performance of the property. The value of this transaction to you depends on tax and other factors, which should be evaluated by your tax and financial advisors. You and your advisors should conduct a careful, independent investigation of the property to determine to your satisfaction, the suitability of the property for your needs.