

RETAIL DEVELOPMENT SITE

1375 New State Highway (Route 44), Raynham, Massachusetts



AVAILABLE FOR GROUND LEASE OR BUILD-TO-SUIT

PROPERTY HIGHLIGHTS

- » Ground Lease or Build-To-Suit Opportunity
- » Up to 3,000 +/-SF
- » Various Layouts Available
- » Zoned Business District
- » Multiple Uses Allowed
- » Drive-Thru Available
- » Neighboring Retailers Include: Walmart, Lowe's, Meineke, Nissan, Subaru, GMC, Chevrolet, KIA, Ford, Gas 44 and more



RETAIL DEVELOPMENT SITE

1375 New State Highway (Route 44), Raynham, Massachusetts

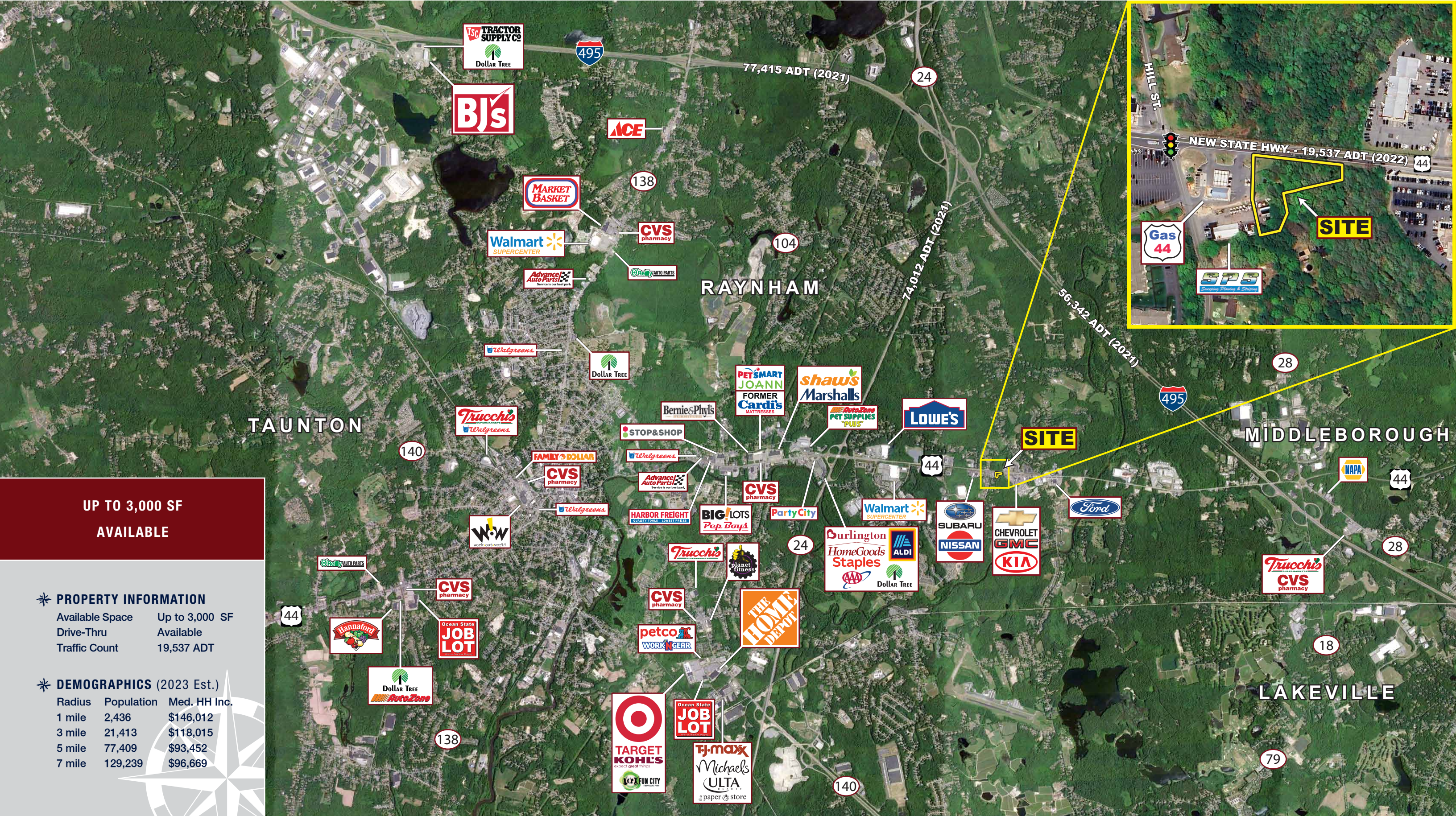

UP TO 3,000 SF
AVAILABLE

✦	PROPERTY INFORMATION		
	Available Space	Up to 3,000 SF	
	Drive-Thru	Available	
	Traffic Count	19,537 ADT	

✦	DEMOGRAPHICS (2023 Est.)		
	Radius	Population	Med. HH Inc.
	1 mile	2,436	\$146,012
	3 mile	21,413	\$118,015
	5 mile	77,409	\$93,452
	7 mile	129,239	\$96,669

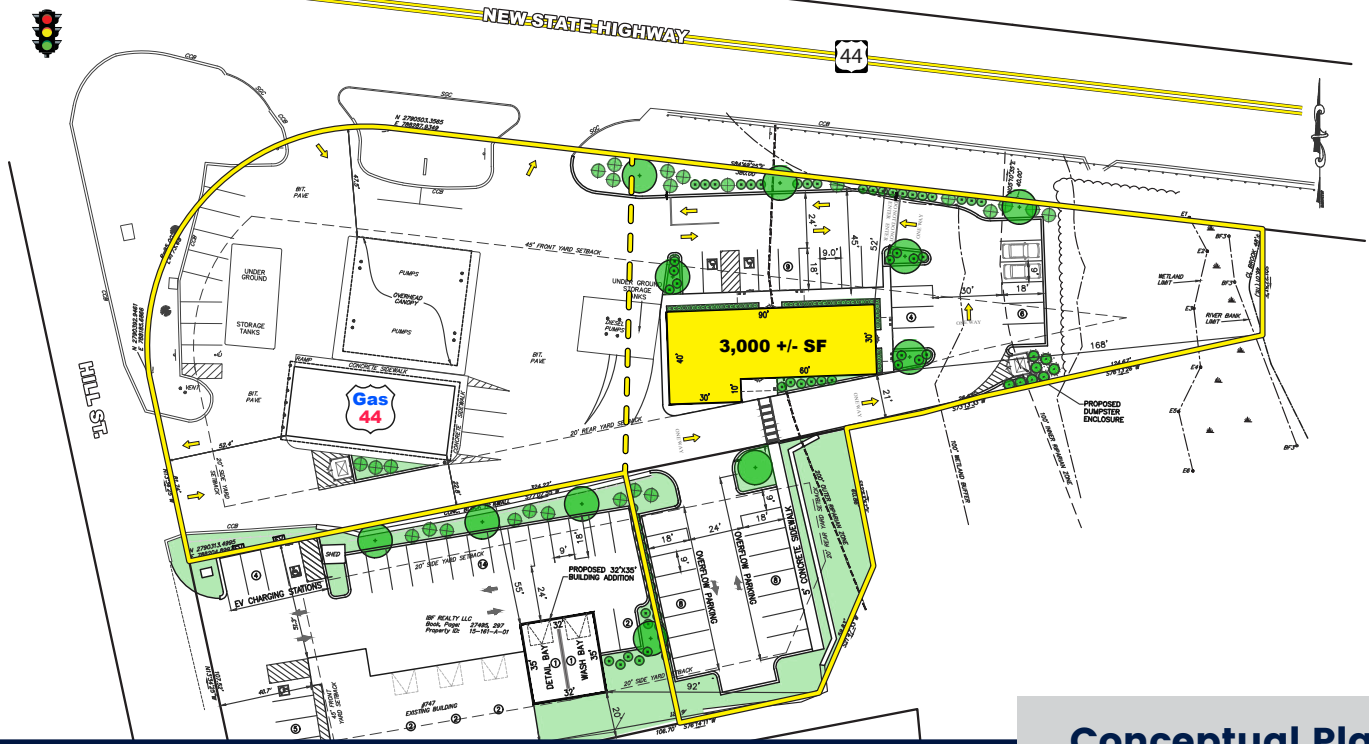

Conceptual Plans

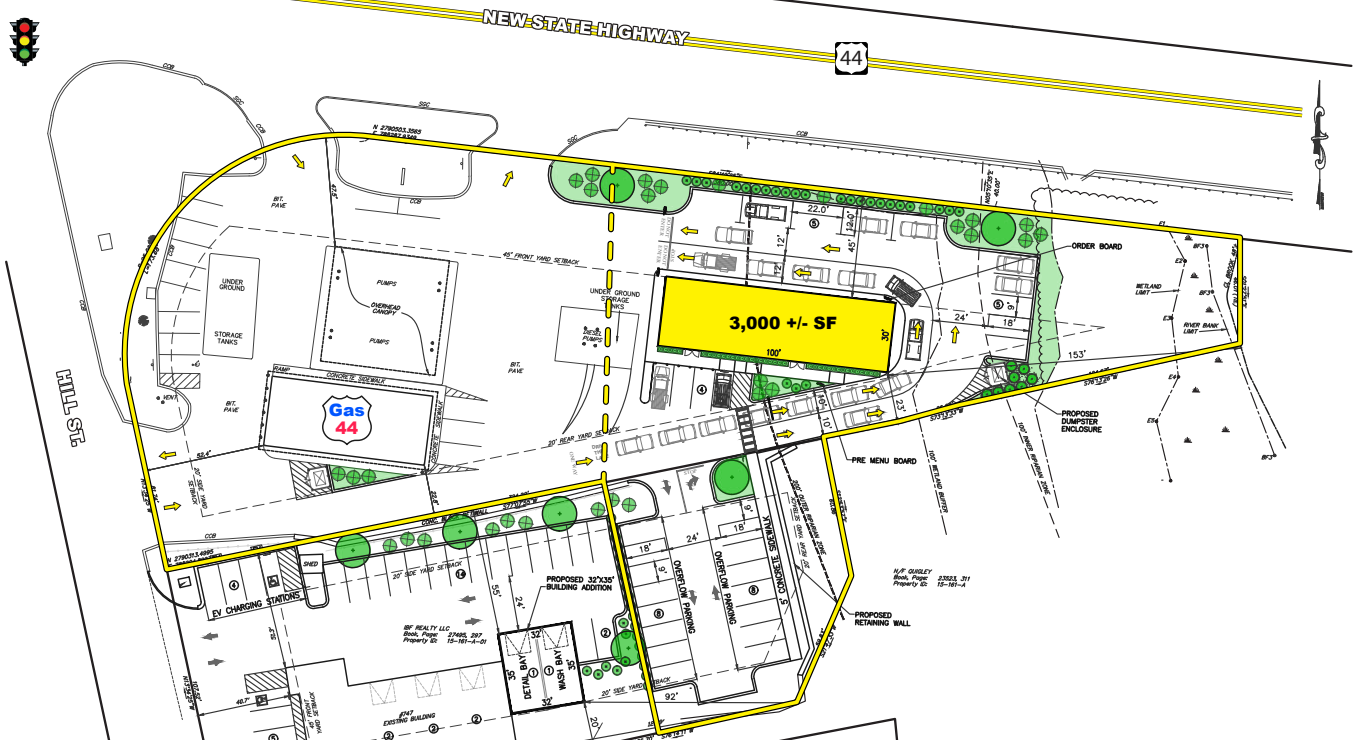

Retail Development Site - 1375 New State Highway (Route 44), Raynham, MA



EASTERN
RETAIL PROPERTIES

FOR MORE INFORMATION CONTACT:

Vin Albanese

781.849.9013 (Office) + 617.413.1193 (Cell)

valbanese@easternretail.com

Tommy Landry

781.849.9015

tlandry@easternretail.com

P 781.849.9010 + F 781.849.9050 + www.easternretail.com + 25 Braintree Hill Office Park, Suite 404 + Braintree, MA 02184

The information above has been obtained from sources believed reliable. While we do not doubt its accuracy, we have not verified it and make no guarantee, warranty or representation about it. It is your responsibility to independently confirm its accuracy and completeness. Any projections, opinions, assumptions or estimates used are for example only and do not represent the current or future performance of the property. The value of this transaction to you depends on tax and other factors, which should be evaluated by your tax and financial advisors. You and your advisors should conduct a careful, independent investigation of the property to determine to your satisfaction, the suitability of the property for your needs.