

Prime Development Site

211 Main Street - Route 18

Weymouth, Massachusetts



SCOPE OF WORK LEGEND

NOTE: THESE DESIGNATIONS ARE SPECIFIC TO EACH DRAWING SHEET. GC SHALL REVIEW SCOPE INDICATED ON EVERY SHEET.

--- HATCH REPRESENTS AREAS OUT OF PROJECT SCOPE. NO WORK SHALL BE DONE IN THESE AREAS, U.N.O.

--- IN-SCOPE WORK IS SPECIFICALLY DETAILED IN THE CONSTRUCTION DOCUMENTS.

--- HATCH REPRESENTS AREAS OF LIMITED SCOPE. SEE NOTE BELOW.

LIMITED SCOPE INCLUDES: GULLY DRAIN, GULLY BASE, ELECTRICAL DEVICE COVER PLATES, SERVICE PANELS AND BOXES.

REPAIR AND PREP EXISTING CONDITIONS AS REQUIRED PRIOR TO PAINTING FOR "LIKE NEW" CONDITION. REPAIR/REPLACE WALL BASES & ELECTRICAL DEVICE COVER PLATES AS REQUIRED. REPLACE DAMAGED OFFSIDERS AND GULLIES TO MATCH ADJACENT SPECIFICATION, AND CLEAN ALL OFFSIDERS AND GULLIES CONTAINING TO REMAIN. THESE ITEMS MUST BE VISUALLY INSPECTED BY THE GC TO DETERMINE SCOPE AND PRICE FOR THE WORK AT THE TIME OF BID. THESE ITEMS ARE NOT SPECIFICALLY INDICATED IN THIS SET OF CONSTRUCTION DOCUMENTS.

SITE DATA

EMPLOYEE PARKING	26
NEW INVENTORY PARKING	163
SALES CUSTOMER PARKING	15
SERVICE CUSTOMER PARKING	13
USED INVENTORY PARKING	31
SERVICE PARKING	9
TOTAL PARKING	267
SITE SF	90,842 SF
EXISTING BUILDING FOOTPRINT	18,682 SF
PROPOSED BUILDING FOOTPRINT	20,140 SF
TOTAL SF	38,822 SF

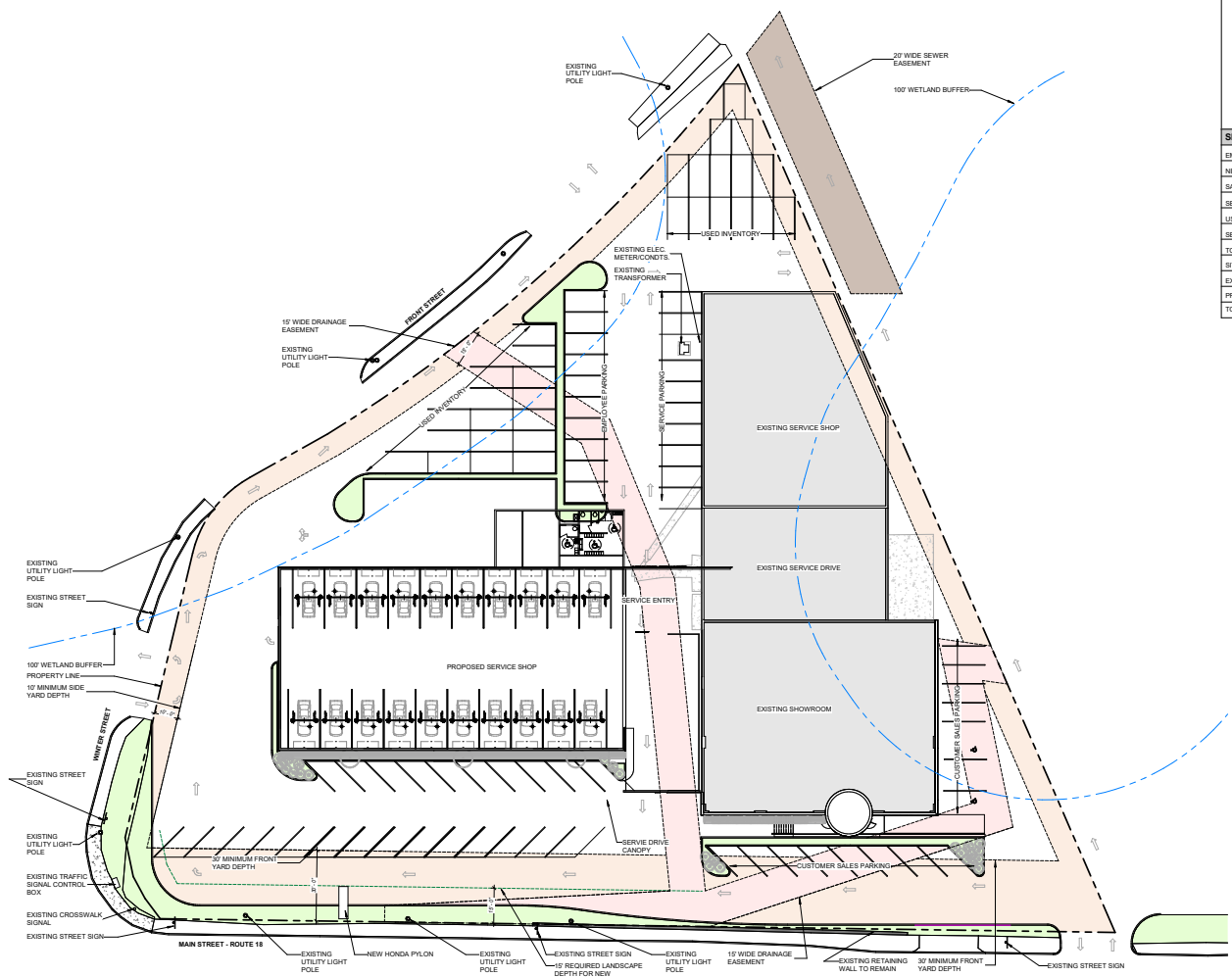

RENOVATION / ADDITION
OCEAN HONDA OF WEYMOUTH

PROPOSED SITE PLAN
 - 200 -

